



Replacement Hover Mower Engine



Model: CER800U

Introduction

Read this information carefully to learn how to prepare, operate and maintain your product properly and to avoid injury and product damage. You are responsible for operating the product safely.

Important: This engine is not equipped with a spark arrester muffler. It is a violation of California Public Resource Code Section 4442 to use or operate the engine on any forest-covered, brush-covered, or grass-covered land. Other states or federal areas may have similar laws. This spark ignition system complies with Canadian ICES-002.

The enclosed Engine Owner's Manual is supplied for information regarding the US Environmental Protection Agency (EPA) and the California Emission Control Regulation of emission systems, maintenance, and warranty. Replacements may be ordered through the engine manufacturer – Maruyama US.

Carton Contents

- Maruyama CER800U Engine w/ throttle cable & spring.
- On/Off switch & wire
- Engine owner's manual / emission system warranty.
- Impeller remover / instructions.
- Engine mounting bolts & washers.
- Blade / impeller mounting bolt.
- Stop lever return spring.



Engine Installation

NOTE: This pertains to installation on California Trimmer and Greenman brand hover mower decks. After removing the previous engine and the mounting base, verify the plastic spacer inserts are remaining.



Place the mounting base onto the underside of the new engine verifying that it's in the correct position with the triangle mark pointing to the top of the engine / front of mower.

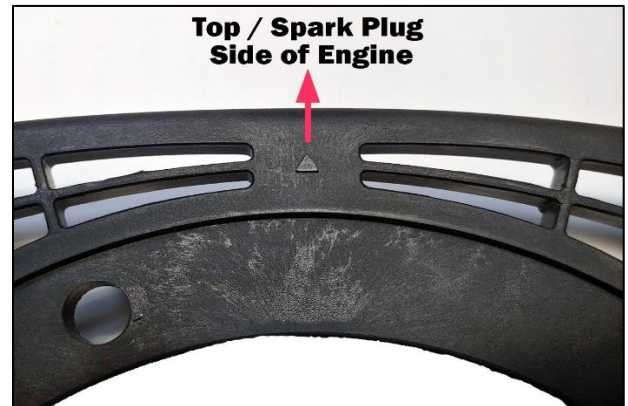

Insert bolts (with washers / spacers) then turn by hand to make sure they are threaded straight before tightening.



Stop Lever Return Spring & On/Off Switch

Remove the stop lever on the **OPERATOR'S RIGHT**

SIDE, place the return spring on the lever end, and insert the spring end into the handle hole above as shown:

Install the on/off switch on the **OPERATOR'S RIGHT** side of the handle (in **SECOND** hole below stop lever).

Attach the throttle spring to the hole of the stop lever on the **OPERATOR'S LEFT** side of the handle, then install the cable adjust bracket onto the handle using the **SECOND** hole below the stop lever:

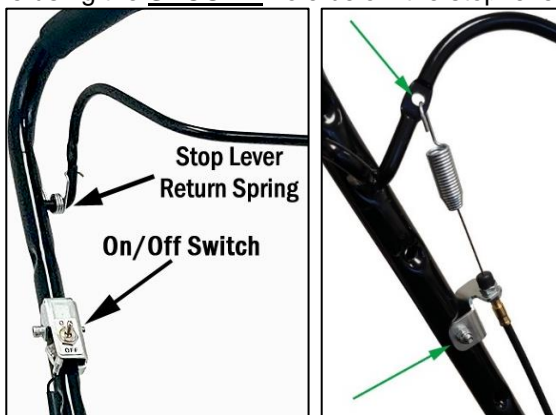
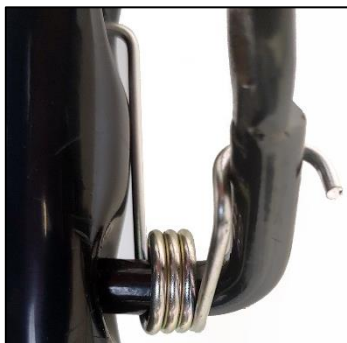

Engine Operation

IMPORTANT – THIS IS A 2-STROKE ENGINE THAT REQUIRES MIXED FUEL OF GASOLINE AND 2-STROKE OIL FOMULATED FOR USE IN HIGH-PERFORMANCE AIR-COOLED ENGINES.

Review the complete operation and safety instructions provided in the **Maruyama engine owner's manual** – which is included in the information packet. Any service, warranty or replacement parts issues for the engine should be directed to Maruyama Authorized Service Dealers. More information can be found on their website at:

Maruyama-us.com

Operating Controls

⚠ WARNING

Make sure the handle sections are properly tightened in the upright position before starting engine and do not operate the unit if the engine stop lever is damaged or not functioning correctly.

Operating Controls (continued)

1. Engine Stop Lever

This lever allows the engine to start and run at its optimum speed. It will also stop the engine and the rotation of the cutting blades when released:



2. Engine On/Off Switch / Throttle Cable

The switch is connected to the ignition system with on and off positions. The throttle is set up to provide the optimum engine speed when the stop lever is fully squeezed against the handle and stop the engine when released – this can be adjusted using the cable adjustment:

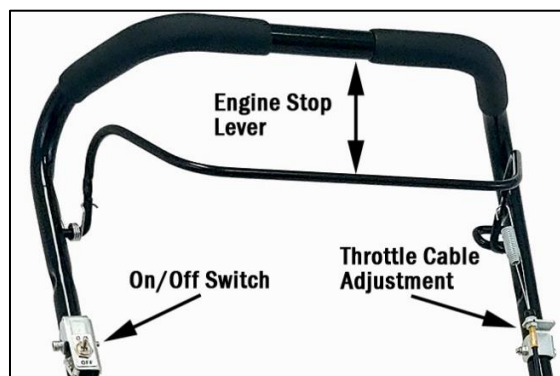

Mower Operation

⚠ WARNING

Make sure the ground is flat and clear of debris and do not attempt to start on a sloped / inclined surface. Make sure the fuel tank cap is properly installed and tightened.

NOTE: FOLLOWING IS A SUMMARY OF THE ENGINE STARTING PROCEDURES. FOR MORE DETAILED INFORMATION, REFER TO THE MARUYAMA ENGINE OPERATOR'S MANUAL.



Mower Operation (continued)

1. Cold Starting

- a. Set the on/off switch to "ON"
- b. Press the primer bulb multiple times until fuel can be seen flowing through the return line to the tank (clear flow with no bubbles).
- c. Move the choke lever to the "CLOSED" position.

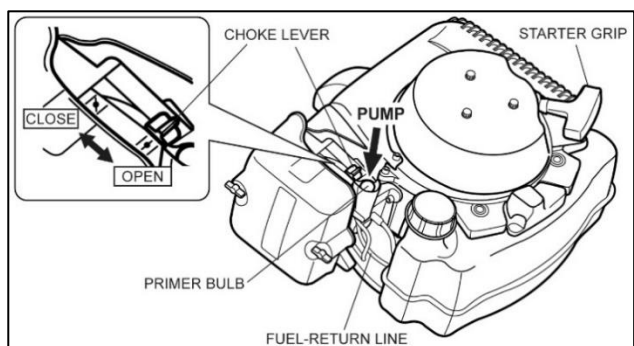

- d. While standing on the right side of the unit, place your foot on the edge of the deck while simultaneously gripping the engine starter handle and the engine stop lever against the handle to hold the unit before pulling the recoil starter:



Mower Operation (continued)

Pull the starter rope out slowly about 6-8" before beginning the full pulling motion and do not pull it all the way out. After the engine has started, move choke lever to the OPEN position, then carefully move behind the unit while continuing to hold the stop lever against the handle, adjusting your grip position using **both hands**.

⚠ WARNING

Always maintain a firm grip on the handle and engine stop lever and keep the unit in front of you. If the engine does not start after 4-5 pulls, make sure the on/off switch is on and repeat the priming steps. If mower should vibrate abnormally, stop the engine and check for the cause. Vibration is generally a sign of an issue with the impeller fan or cutting blade underneath the deck.

2. Mowing

⚠ DANGER

Always use both hands when operating the unit. Steep slopes are a major factor related to slip and fall accidents, which can result in severe injury. Operation on all slopes requires extra caution. Never operate the mower at an angle greater than 45 degrees or above your position. If you feel uneasy on a slope, do not mow it. Do not pull the unit directly backwards when mowing.

- Always keep the unit below your position moving it with side-to-side motion like a pendulum. Exercise extreme caution when changing direction on slopes.
- Watch for holes, ruts, bumps, rocks, or other hidden objects. Uneven terrain could cause a slip and fall accident. Tall grass can hide obstacles.
- Do not mow wet grass on excessively steep slopes. Poor footing could cause a slip and fall accident.
- Take extra caution near drop-offs, ditches, or embankments. Wear shoes with traction as you could lose your footing or balance.
- When cutting steeper inclines from the top of the slope and a longer reach is needed, never tie a rope to the unit. Use the handle extension kit option (order #4012561-M):

